

**Owners Manual For
Retractable Awning
SKU# 433-0876
Model# 30102**

IMPORTANT!

- **HAVING PROBLEMS?**
- **INSTALLATION QUESTIONS?**
- **NEED PARTS?**
- **TROUBLESHOOTING?**

**PLEASE DON'T RETURN THIS
PRODUCT TO THE STORE**

CONTACT US FIRST

Customer Support
1-800-495-9278

Monday-Friday: 8am-5pm Central Time

CAUTION:

**Do not remove restraining straps until after unit is completely
installed - the unit needs to be closed and secure during installation.**

Installation Instructions

Thank You for your purchase of our product. The following contains assembly instructions as well as care and maintenance suggestions. Please take a moment to completely read and familiarize yourself with this information. If you have any questions regarding your purchase, please contact us at 1-800-495-9278

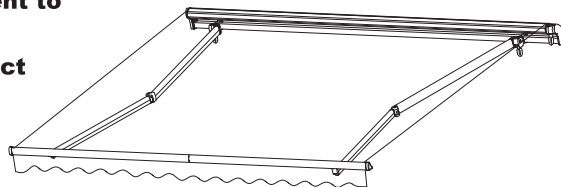

WARNINGS

Please read and understand the following safety warnings to prevent personal injury and/or damage to your product

1. To avoid possible personal injury and/or damage to the awning make sure it is securely attached to your structure.
2. Do not use your awning when high winds are present. Excessive wind speeds may cause damage to your Decko awning and/or structure. Wind damage or storm damage is not covered by the warranty. The max recommended wind speed is 23 mph when awning is extended.
3. Keep fingers clear of all moving parts and hardware, including all pivot points.
4. Never attempt to repair or disassemble the extension arms. The extension arms are under high tension and can cause serious injury and/or damage.
5. Don't install your awning near a furnace or fireplace exhaust vent as high heat may damage your awning.
6. The awning is not made to support additional weight. Do not place anything on top of the awning as this may cause the awning to collapse.
7. This product is designed for stationary installation, when installed on a rv or mobile home application it is recommended to be removed during transit.
8. It is recommended to keep the adjustment handle in storage out of reach of children.

AWNING MUST BE SECURELY ATTACHED TO THE STRUCTURAL SUPPORTS OF YOUR HOME. DO NOT ATTACH AWNING DIRECTLY TO SIDING, STUCCO, OR OTHER NON SUPPORTIVE WALL MATERIALS. IF YOU HAVE QUESTIONS REGARDING INSTALLATION CALL 1-800-495-9278

MAINTENANCE

Very little maintenance is required for your awning. Periodically check all fasteners to make sure they are properly secured. Re-tighten if necessary. Inspect fabric once a month for signs of wear. Clean with a garden hose.

Note: Please read the instructions completely before beginning the installation of your Decko Retractable Awning.

Note: Before installation please inspect your awning and its parts for damage. Damaged parts should not be used. If you have questions or concerns about your awning or its parts please contact us at 1-800-495-9278. Please read the installation manual thoroughly before attempting to install your awning. Please have all the required tools ready and available prior to installation, ensure that all parts are included.

Tools Required for Assembly

- | | |
|-----------------------------------|--------------------------------------|
| 1. Drill | 5. 1/4" drill bit |
| 2. Measuring tape (12' or longer) | 6. 9/16" socket or adjustable wrench |
| 3. Level (4' or longer) | 7. Two step ladders |
| 4. Stud finder | 8. Pencil and chalk line |

Awnings Parts List

A Awning Framework QTY: 1

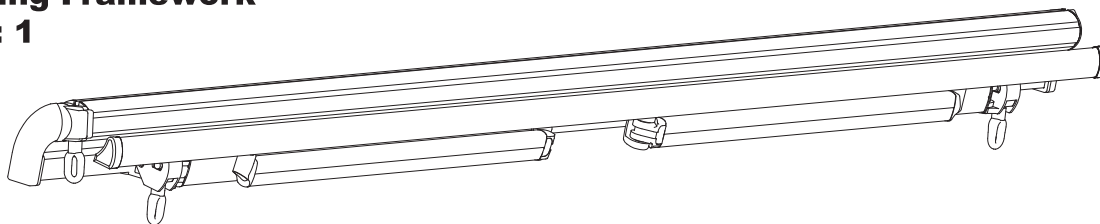

B Adjustment Handle QTY: 1 #30100-B

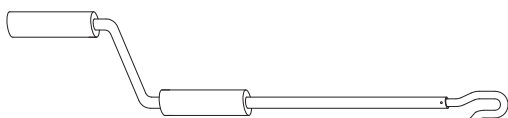

D Bracket Lag Bolts QTY: 6 #30100-D



F Adjustment Eyelet Secure Pin QTY: 3 #30100-F



C Mounting Bracket with Retaining Bolt QTY: 3 #30100-C

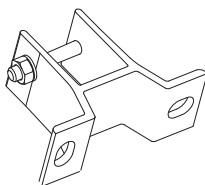

E Adjustment Eyelet QTY: 3 #30100-E

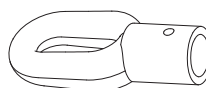

Step 1 Determine Bracket Mounting Height

Note: It is necessary for the mounting brackets to be properly attached to the exterior wall. Failure to mount the brackets properly may cause your awning to collapse and cause personal injury or property damage. See step 3. A minimum of 8" clearance is required from the centerline of the mounting brackets when mounting near roofs overhangs, doors or windows.

The Recommended pitch for the awning is 1 to 2 inches per foot of extension.

How to Calculate Awning Mounting Height:

1. Determine the awning extension length you desire. (1. Example 10')

2. Determine the headroom clearance you will need for the awning extension length from step 1. (2. Example 84")

3. Calculate the awning drop using the following formula.

Awning drop = Pitch (Recommended 1" to 2") x Extension

(Example A: 2" pitch x 10' Extension = 20" Drop)

(Example B: 1" pitch x 7' Extension = 7" Drop)

Enter your measurements Here

Pitch _____ x Extension _____ = Drop _____

4. Calculate Bracket Height

Mounting Bracket Height = Drop + Headroom Clearance + Bracket Height

(Example: 20" Drop + 84" Headroom + 3" = 107" Awning Mounting Height)

Enter your measurements Here

Drop _____ + Headroom Clearance _____ + 3" = Bracket Mounting Height

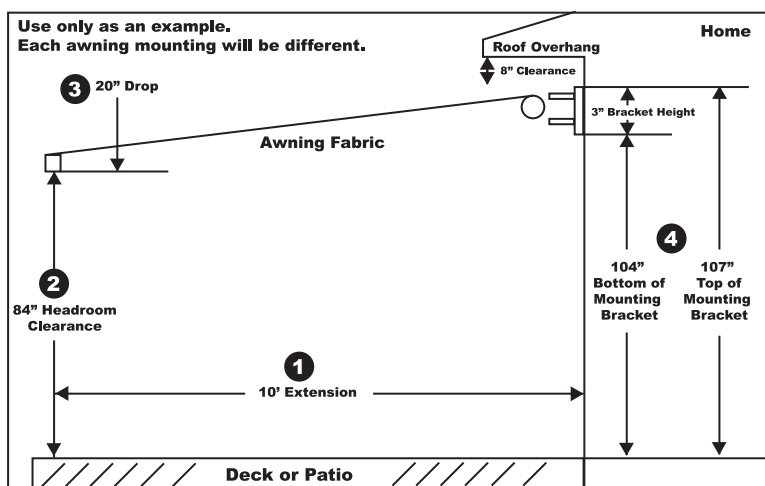

Step 2 Marking The Mounting Bracket Line

Note: A minimum of 8" clearance is required from the centerline of the mounting brackets when mounting near roofs overhangs, doors or windows.

How to mark the location of the mounting brackets:

1. By using the bracket mounting measurement (Example 107") calculated in step 1, measure from the base up to make two even sized marks 12' apart.

2. By using a chalk line snap a level* chalk line using the two marks from step 1.

***NOTE:** This line must be level. Do not rely on structural lines such as siding, etc., on the exterior wall.

Stud Wall

3. Using a stud finder locate and mark all the stud centers located along the new level chalk line. You will use these marks as reference when installing the mounting brackets.

Cement/Brick Wall

3. Mark three evenly separated marks along the 12' wide level chalk line. You will use these marks as reference when installing the mounting brackets.

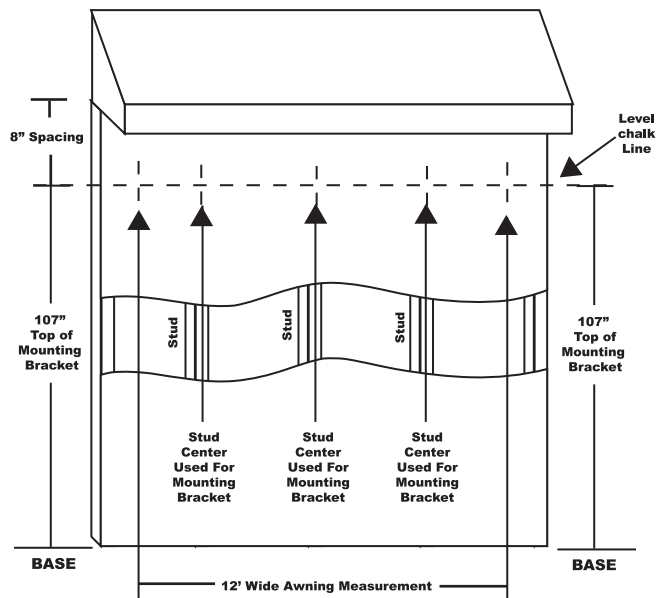

Step 3 Attaching the Mounting Brackets

Note: It is essential for the mounting brackets to be securely attached to the structural support located behind the exterior wall. (Example Wood Studs) The brackets need to be secured with lag bolts (on siding, stucco and wood surfaces) and concrete anchors*. (in masonry, concrete and brick walls, *Sold Separately)

How to attach the mounting brackets into wood studs:

1. Line up one mounting bracket (C) with each stud center line and level chalk line created in step 2. Make sure to line up the top of each bracket with the level chalk line.

2. While in position mark both holes of each mounting bracket using a pencil.

3. On each mark, drill a 1/4" wide x 3-1/2" deep hole. Drilling holes this deep will prevent the wood from splitting.

4. Using the six bracket lag bolts (D) attach the three mounting brackets (C) using a 9/16" wrench.

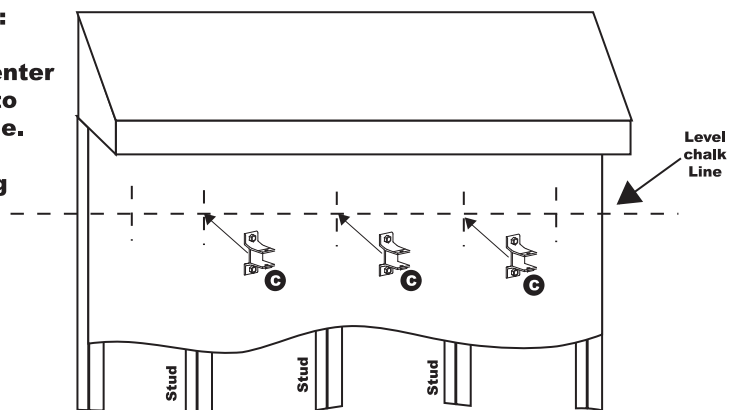

Note: For wall mounting with siding use nylon spacers, spacers not included**.

Note: Masonry, Concrete and Brick wall mounting will require use of concrete anchors (sold separately). Use the appropriate sized drill bit with the proper fastener for the concrete anchors.

Flat Wall Mounting

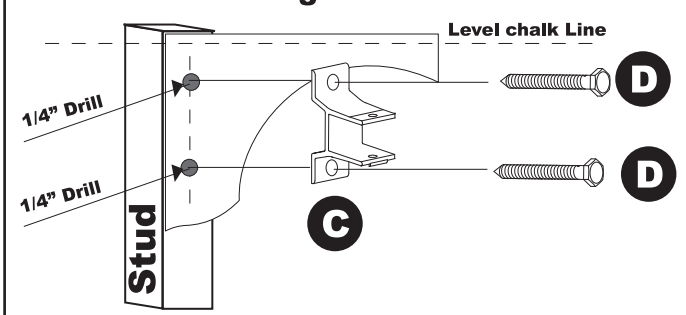

Wall Mounting with nylon spacers (spacers not included)

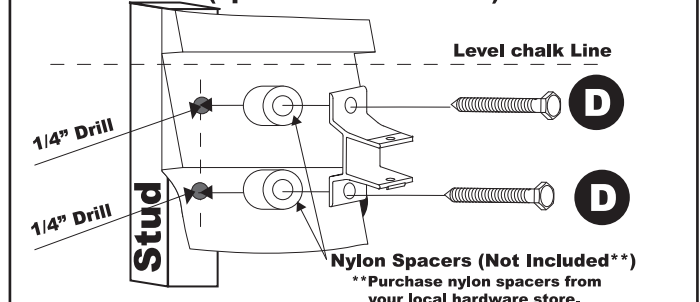

Step 4 Attaching the Awning Framework

CAUTION: Do not remove restraining straps until after the unit is completely installed - the unit needs to be closed and secure during installation.

How to attach the Awning Framework:

1. Remove all three awning bolts from the three mounting brackets (C).
2. With two ladders and the help of another person slide the awning framework (A) onto the three mounting brackets (C).
3. Secure the awning frame work using the three awning bolts. Tighten with a wrench to secure.

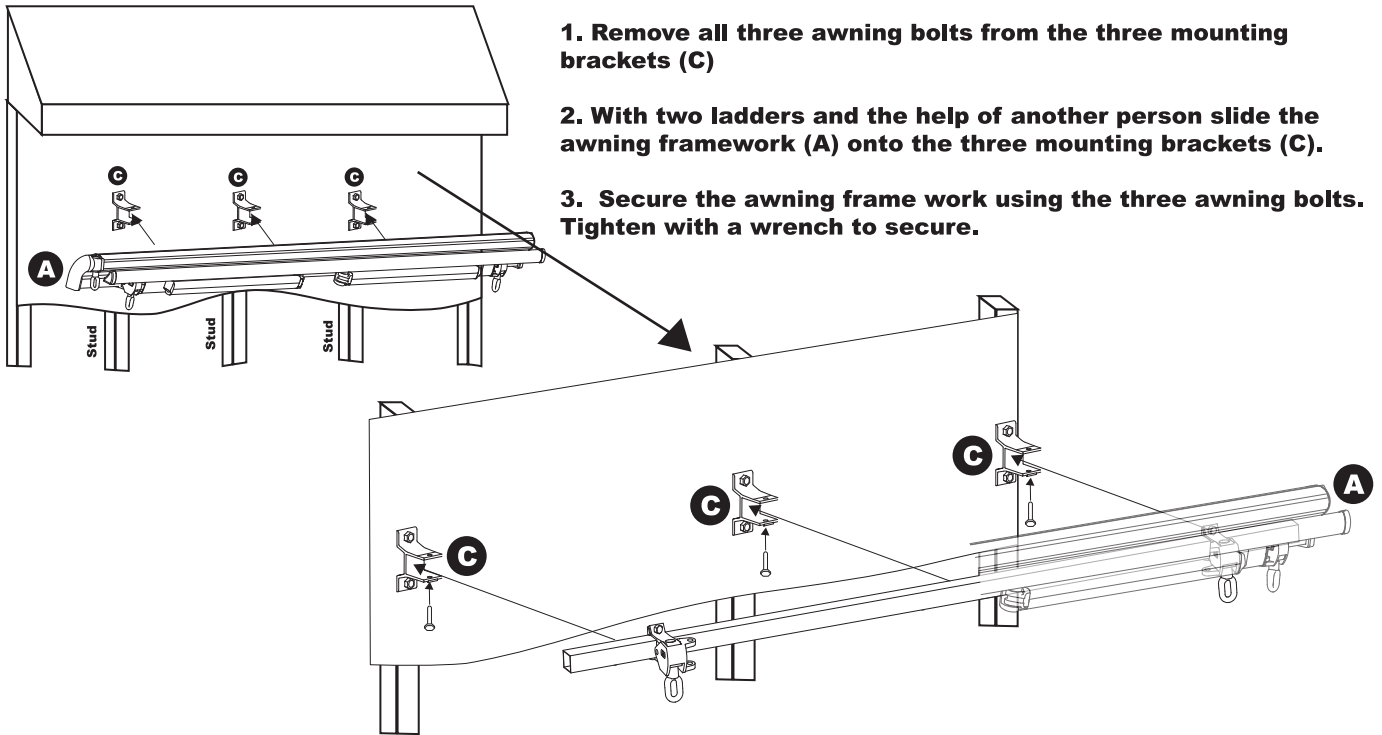

Step 5 Installing Adjustment Eyelets and Handle

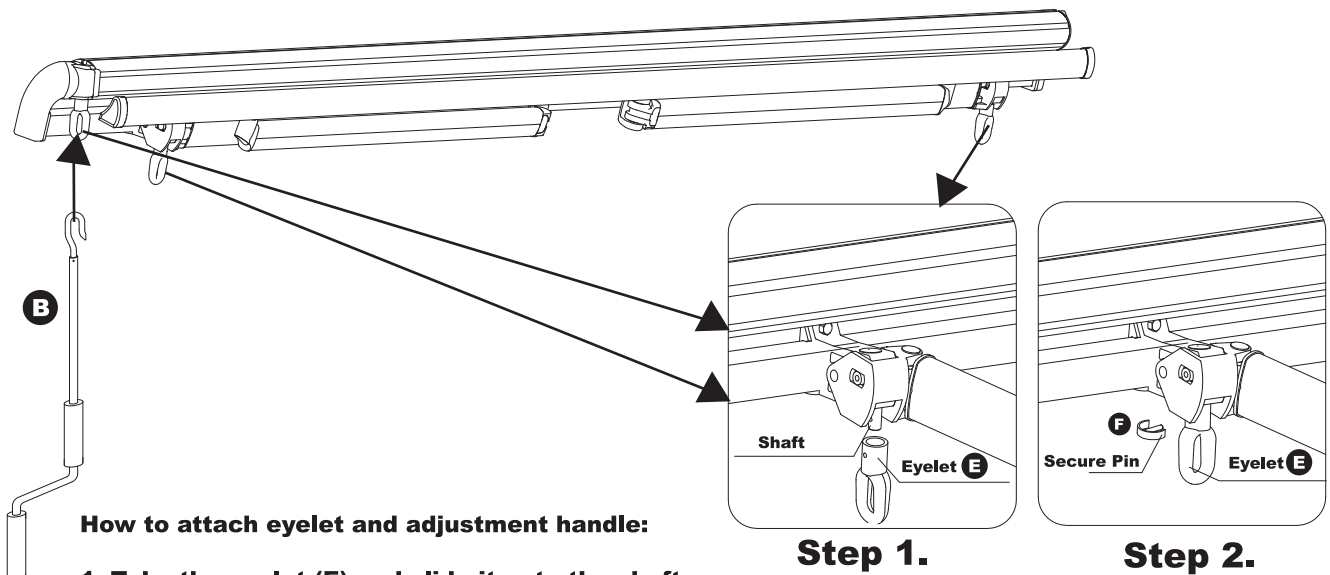

How to attach eyelet and adjustment handle:

1. Take the eyelet (E) and slide it onto the shaft.
2. Once on the shaft slide one secure pin (F) into the side of the eyelet (E).
3. Attach the adjustment handle hook (B) to the adjustment eyelet (E).

Step 1.

Step 2.

Step 6 Extending the Awning

WARNING! The extension arms are under high tension and can cause serious injury and/or damage. Stand clear of extension arms as you remove the restraining straps.

CAUTION! NEVER ATTEMPT TO REPAIR OR DISASSEMBLE THE EXTENSION ARMS!

The extension arms have been carefully aligned and calibrated at the factory and need no adjustment.

How to extend the awning:

1. **CAREFULLY** release the restraining straps from the awning.
2. Turn the adjustment handle (B) in a circular motion until the awning is fully extended*.

* The extension arms will not be completely straight when the awning is fully extended, there will be a slight bend that remains. This bend has been engineered to allow the awning to retract smoothly.

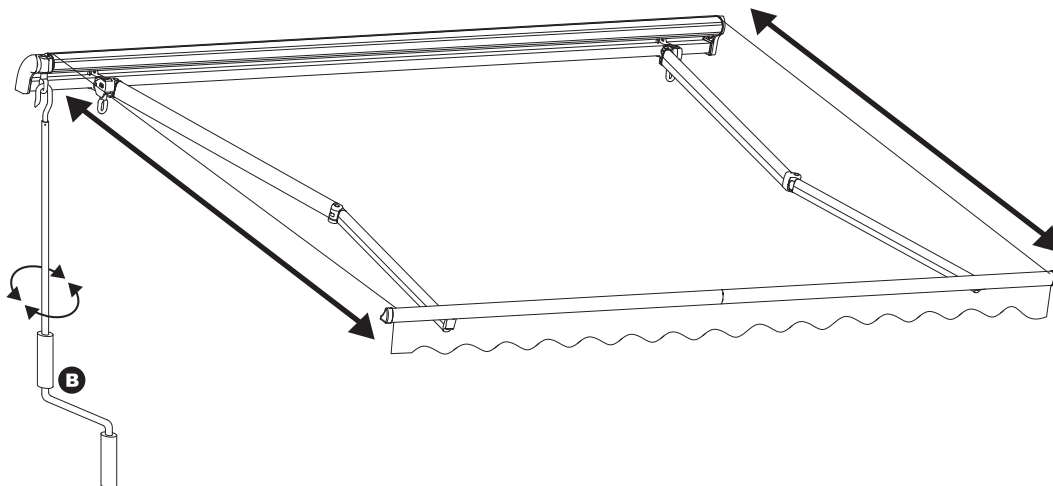

Step 6 Adjusting the Pitch

How to adjust the pitch:

1. Adjust the awning to the full extension using the adjustment handle (B).
2. Attach the adjustment handle (B) to pitch adjustment eyelet (E) on the left side of the awning. By turning the adjustment handle (B) raise or lower the pitch of the awning to the desired height*.
3. Attach the adjustment handle (B) to pitch adjustment eyelet (E) on the right side of the awning. By turning the adjustment handle (B) raise or lower the pitch of the awning to the desired height*.

*Use the bubble level located on the awning to check level. Awning must be level for proper operation

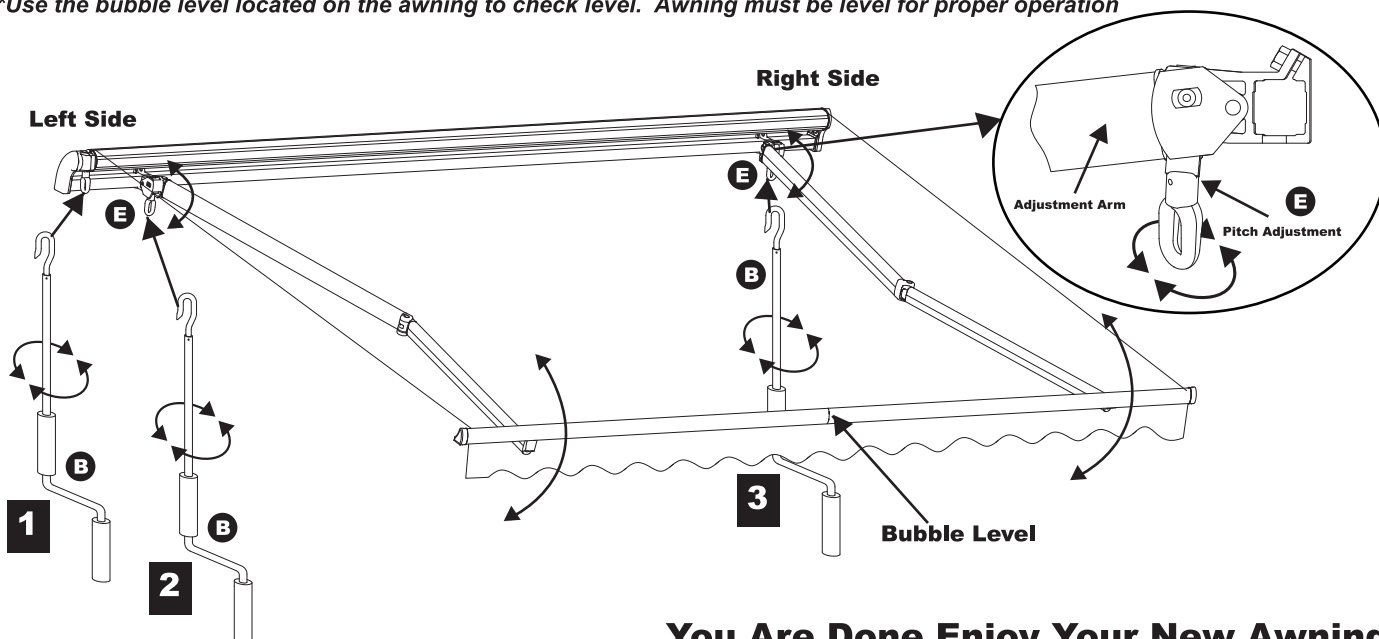

You Are Done Enjoy Your New Awning

Retractable Awning Product Warranty

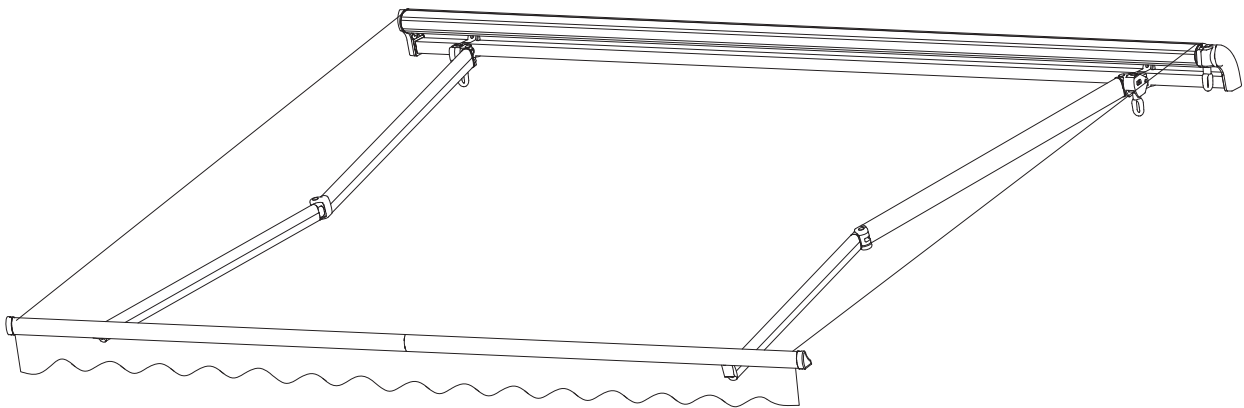

MANUFACTURER'S LIMITED WARRANTY:

This product is covered under the manufacturer's 1 year limited warranty against defects in workmanship and materials. If your Backyard Creations® furniture fails structurally during normal use within one year of purchase, the manufacturer will repair or replace the defective piece at no charge. The warranty excludes furniture used for commercial purposes, furniture damaged by acts of nature, abuse or lack of proper care or use of improper hardware. Proof of purchase (dated register receipt) is required for warranty claims.

Decko Products
2301 Traffic Street NE
Minneapolis, MN 55413
1-800-495-9278